

Model	Enclosure Design	Frequency Response	Efficiency	Power / imp.
SoundSS s2	vented sub	46Hz - 133Hz (-3dB)	98dB 1W/1M	450W AES/8ohm
Components	Kast: Fins multiplex 18mm			Netto inhoud: 145Ltr
	Bass: 18Sound 15W700 38Hz-5000Hz/450W/8ohm			
	Highpass 30Hz / Lowpass120Hz - 4de order / 120Hz/Q=2/G=+2dB			
Ontwerp: van den Hoogen's Servicebedrijf / Boi van den Hoogen / www.boyzpc.nl / 20-01-2006				

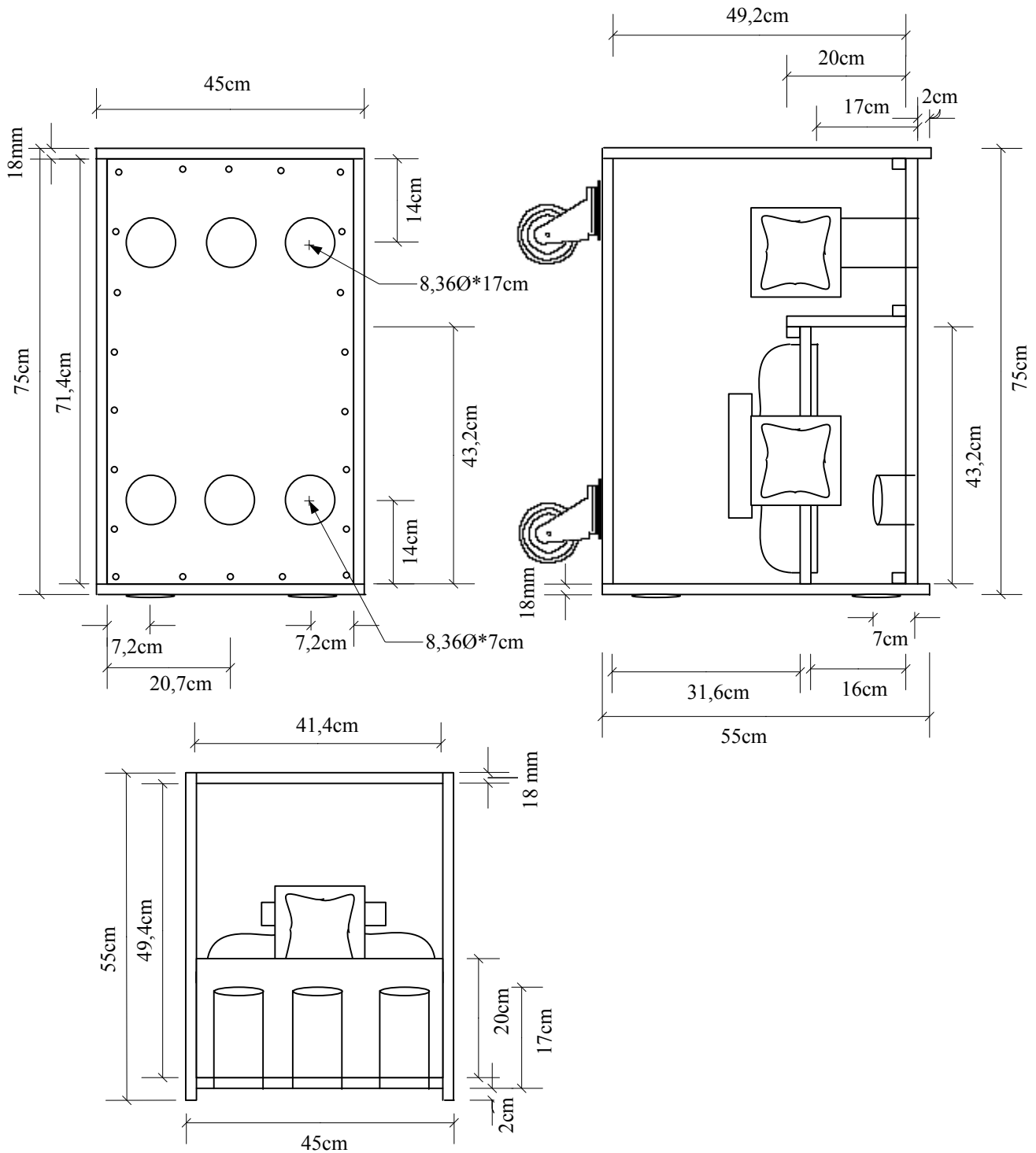

Model	Enclosure Design	Frequency Response	Efficiency	Power / imp.
SoundSS s1	Band pass sub	48~ 136Hz -3dB	98dB 1W/1M	450W AES/8ohm
Components	Kast: Fins multiplex 18mm		Netto inhoud: r110,5Lts / f28,5Lts	
	Bass: 18Sound 15W700 38Hz-5000Hz/450W/8ohm			
	Highpass 30Hz / Lowpass120Hz - 4de order 120Hz/Q=2/G=+2dB			
Ontwerp: van den Hoogen's Servicebedrijf / Boi van den Hoogen / www.boyzpc.nl / 20-01-2006				

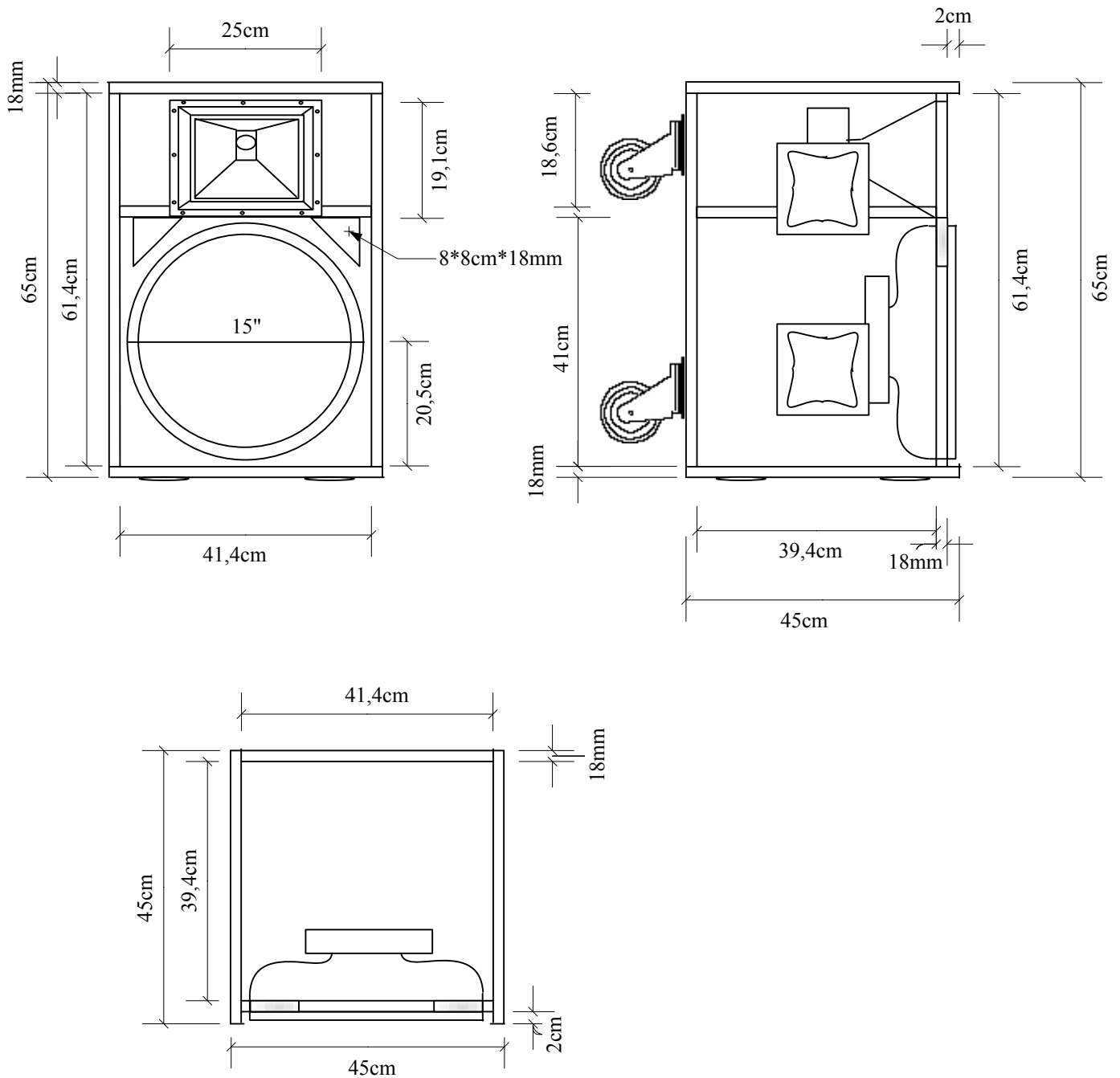

Model	Enclosure Design	Frequency Response	Efficiency	Power / imp.
BT15152	Top vented	113~20KHz -3dB	98,5dB 1W/1M	450W AES/8ohm
Components	Kast: Fins multiplex 18mm			Netto inhoud: 67Lts
	Bass/mid: 18Sound 15ND930 50Hz-2500Hz/500W/8ohm		Passief filter 1200Hz 12dB/okt/8ohm	
	Driver: 18Sound ND2060 80w/8ohm/0,8-19Khz / Beyma TD360 60*40hoorn			
	Highpass 120Hz - 4de order / 120Hz/Q=2/G=+1,5dB 300Hz/Q=1/G=-1dB 1000Hz/Q=1/G=+5dB			
Ontwerp: van den Hoogen's Servicebedrijf / Boi van den Hoogen / www.boyzpc.nl / 20-01-2006				