

Bass: B&C 18PZB100 40-2000Hz/700W/8ohm 96,9dB 1W/1M 37~ 110Hz -3dB  
 Laagaf 30Hz / hoogaf 100Hz 8ste order EQ 40Hz/Q=3/G=+3,0dB 60Hz/Q=2/G=+0,5dB 90Hz/Q=2/G=-2,0dB

Model	Enclosure Design	Frequency Response	Efficiency	Power / imp.
LS1200 sub	Bandpass sub	37 ~ 106Hz -3dB	96,9dB 1W/1M	1000W AES/8ohm
Components	Kast: Berken multiplex 15mm			Inhoud kast: r144 /f59 Ltr
	Bass: 18 sound 18LW1400 28-2500Hz/1000W/8ohm			
Laagaf 30Hz / hoogaf 100Hz 8ste order EQ 40Hz/Q=3/G=+3,5dB 100Hz/Q=1/G=-2,5dB				
Ontwerp: van den Hoogen's Servicebedrijf / Boi van den Hoogen / www.soundshopschylge.nl / 15-05-2013				

Bass: Precision Devices PD184 28-2500Hz/600W/8ohm 97,7dB 1W/1M 38,5 ~ 105,5Hz -3dB  
 Laagaf 30Hz / hoogaf 100Hz 8ste order EQ 40Hz/Q=3/G=+3,5dB 100Hz/Q=1/G=-1,0dB

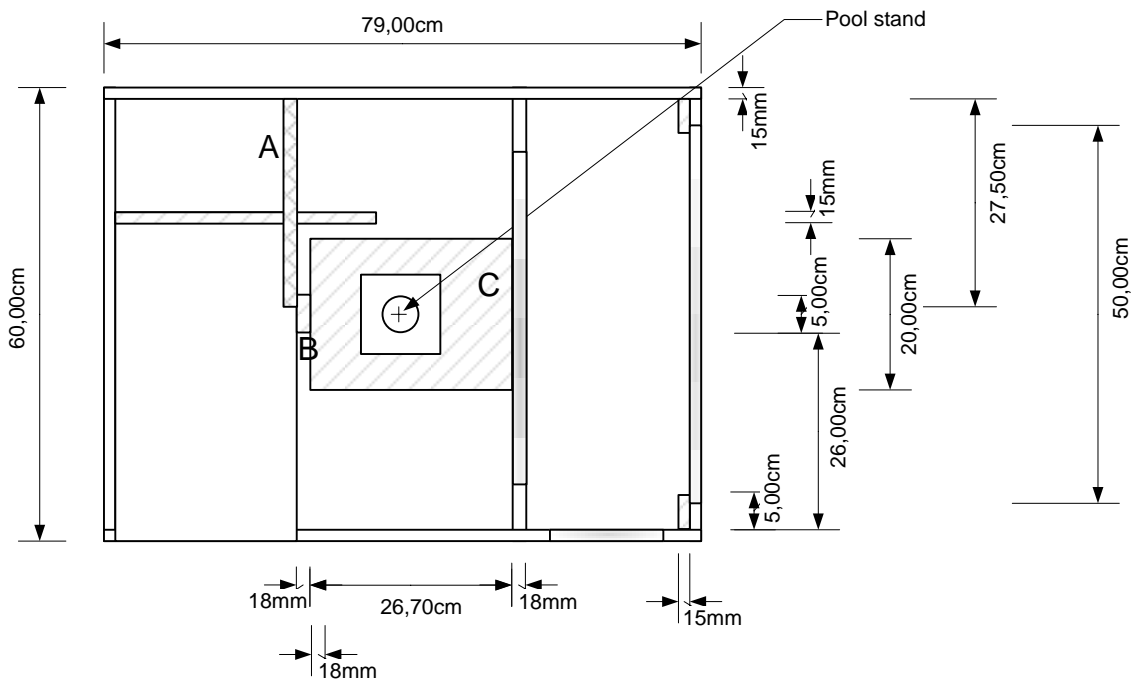
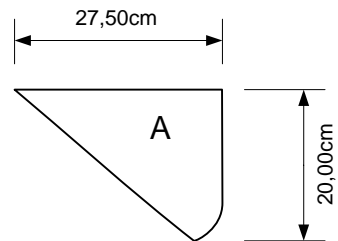
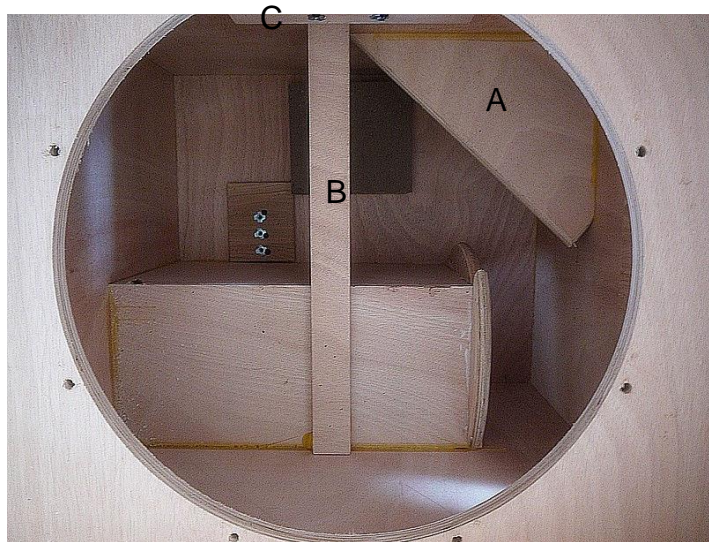
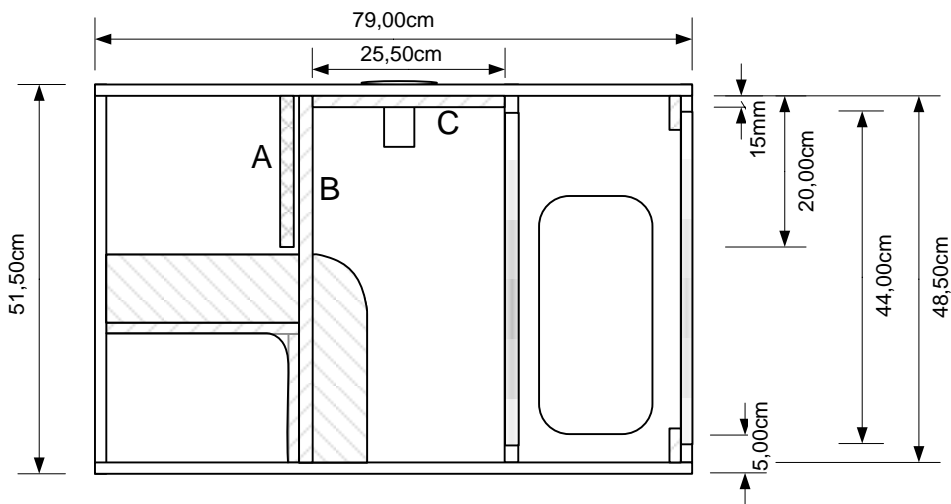

Model	Enclosure Design	Frequency Response	Efficiency	Power / imp.
LS1200 sub	Bandpass sub	~ Hz -3dB	dB 1W/1M	W AES/8ohm
Components	Kast: Berken multiplex 15mm			Inhoud kast: r141 /f57 Ltr
Ontwerp: van den Hoogen's Servicebedrijf / Boi van den Hoogen / www.soundshopschylge.nl / 15-05-2013				