

Technical Specifications

Acoustic cabinet:	SB18
Description:	Bass reinforcement. 18" subwoofer.
Power AES:	1.200 W.
Power Program:	2.400 W.
Sensitivity 2,83v @ 1m:	101 dB.
Max. SPL continuous:	132 dB.
Max. SPL peak:	138 dB.
Frequency response:	33 - 200 Hz
Bass Loudspeakers:	18P1200ND

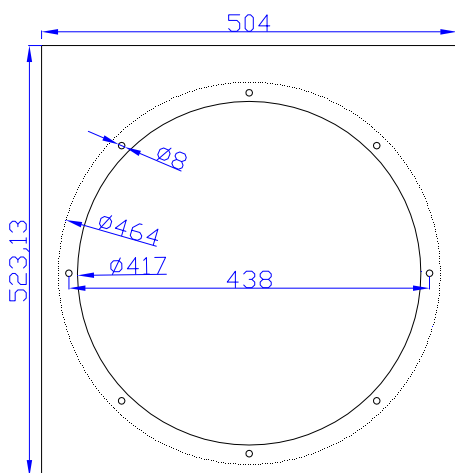

Rear

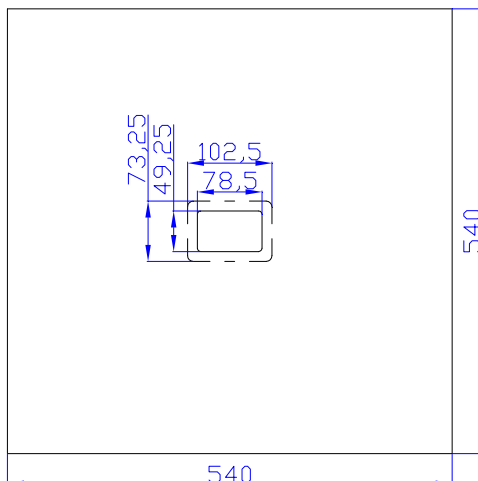

Base

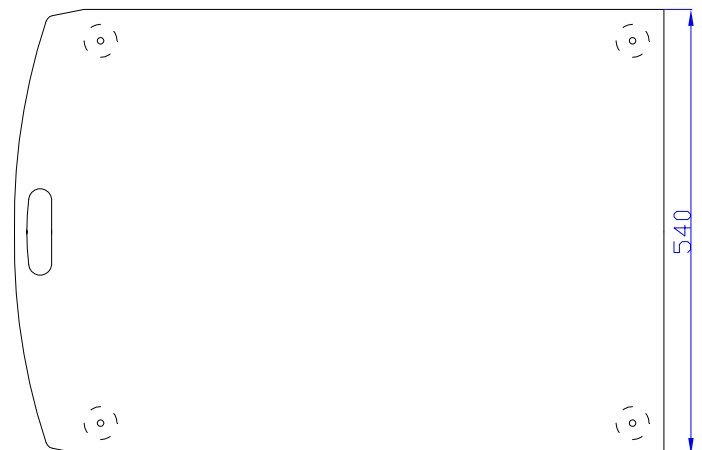

Lateral



Front

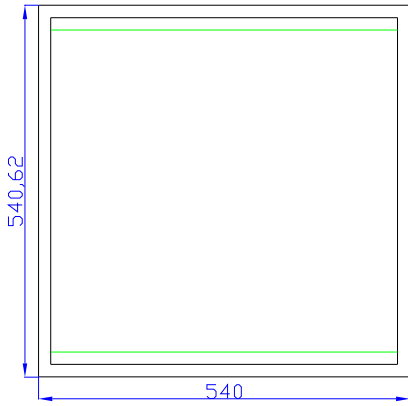

Lateral

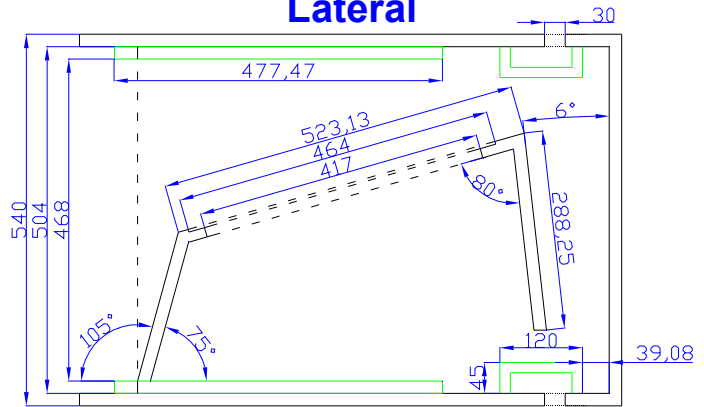

Central

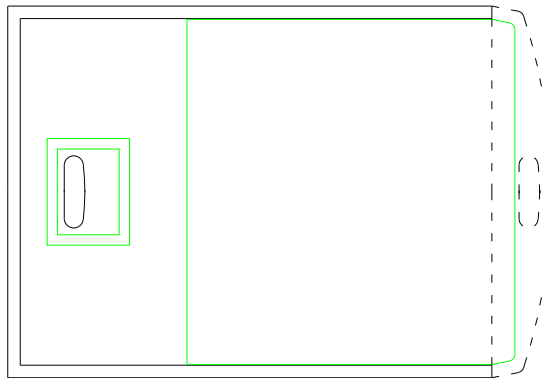

Base

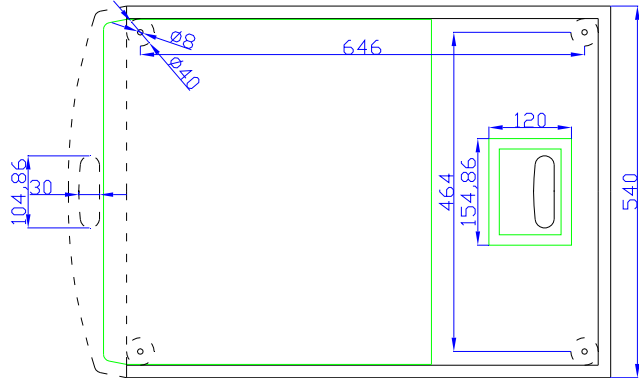

Base

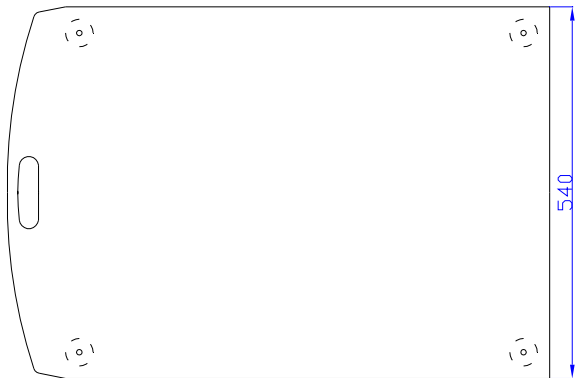
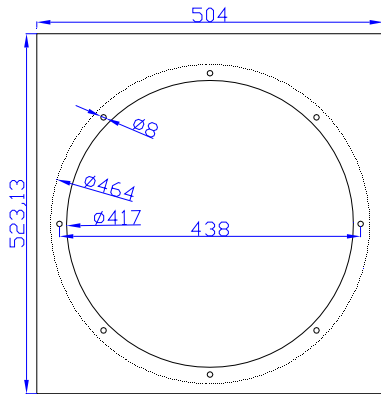

Rear

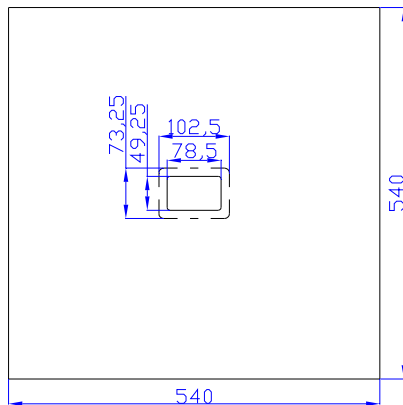

Lateral

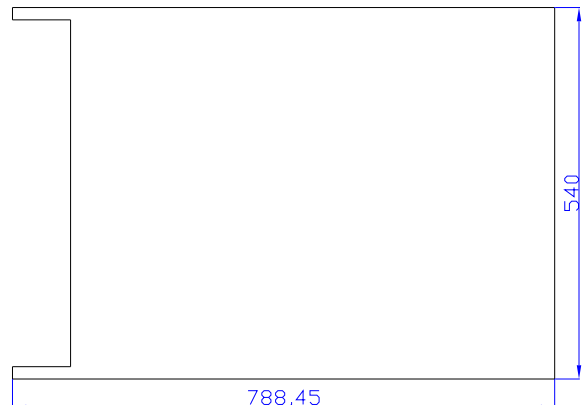

18P1200Nd

KEY FEATURES

- Real 1200 W AES power handling
- Sensitivity: 98 dB @ 2.83V
- 4" Duo Technology voice coil
- Forced air convection circuit for low power compression
- Extended controlled displacement: $X_{max} \pm 9.5$ mm.
- Massive mechanical displacement capability: 52 mm p-p



TECHNICAL SPECIFICATIONS

- | | |
|----------------------------|-----------------------|
| • Nominal diameter | 460 mm. 18 in. |
| • Rated impedance | 8 ohms |
| • Minimum impedance | 6 ohms |
| • Power capacity* | 1200 w AES |
| • Program power | 2400 w |
| • Sensitivity | 98 dB 2.83v @ 1m @ 2π |
| • Frequency range | 25 - 2000 Hz |
| • Voice coil diameter | 100 mm. 4 in. |
| • Magnetic assembly weight | 6 kg. 13.2 lb. |
| • BL factor | 26.3 N / A |
| • Voice coil length | 25 mm |
| • Air gap height | 14 mm |
| • X damage (peak to peak) | 52 mm |

DIMENSION DRAWINGS

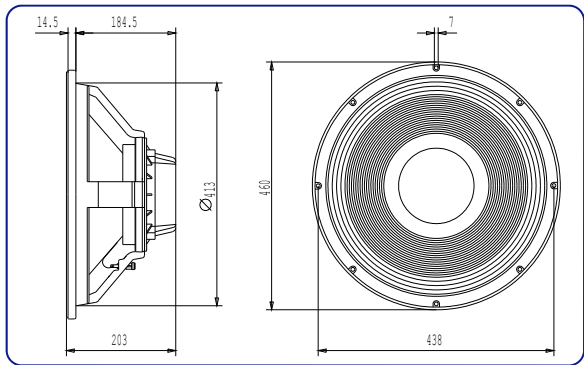

Notes:
 *The power capacity is determined according to AES2-1984 (r2003) standard.
 Program power is defined as the transducer's ability to handle normal music program material.

SB18/1 Presets

The EQ interface features a frequency response graph with a red boost in the 40-100 Hz range. Below the graph, four bands are configured as follows:

Band	Type	Fc	Q	Level
Band 1	Bell	62.5 Hz	2.996	3.0 dB
Band 2	Bell	324 Hz	0.939	0.0 dB
Band 3	High Shelf	1.19 kHz	0.939	0.0 dB
Band 4	Low Shelf	5.04 kHz	0.939	0.0 dB

