

Model	Enclosure Design	Frequency Response	Efficiency	Power / imp.
VA641	Vertical array	62 ~ 20KHz -3dB	97,2dB 1W / 1M	1000W prog.power/ 8ohm
Components	Kast: Berken multiplex 15mm			Netto inhoud 49Ltr
	18Sound 6ND430 200W/92,5dB 63-5500Hz			
	Beyma CD10Fe 70W/109dB 0,7~19KHz + Beyma TD-194 90*40 hoorn			
Highpass 80Hz 8ste order EQ 80Hz/Q=2/G= +0,5dB - passief x-over 1750Hz/12/18dB-okt 8ohm				
Ontwerp: van den Hoogen's Servicebedrijf / Boi van den Hoogen / www.soundshopschylge.nl / 23-02-2012				

Basspoort 110mm buitenmaats 103mm binnenmaats

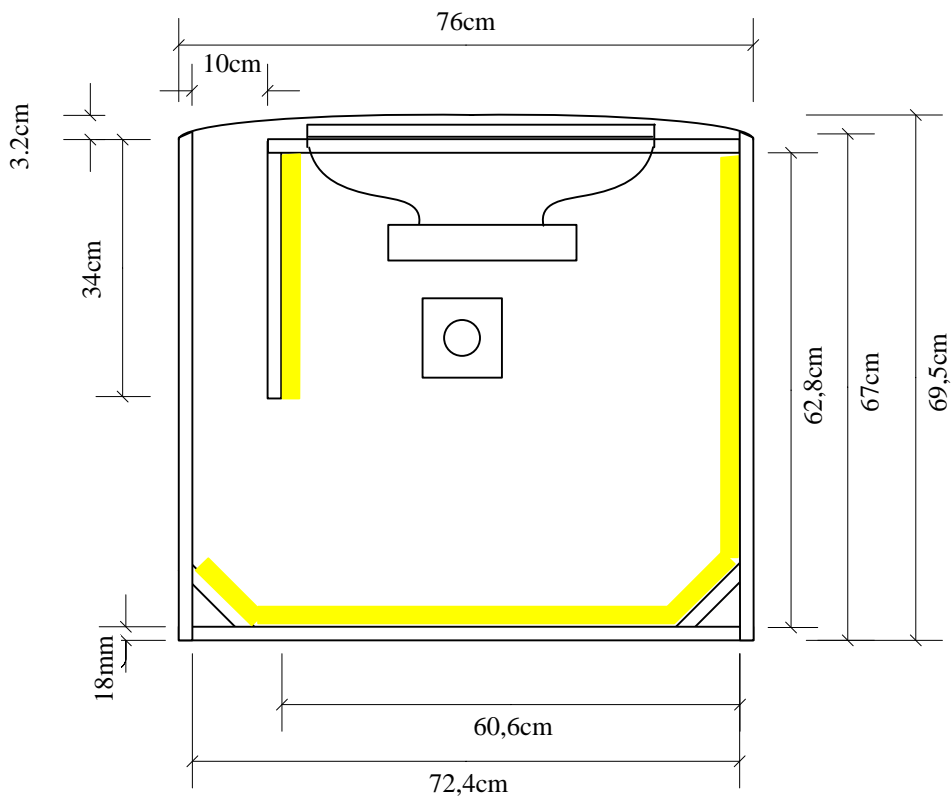

Model	Enclosure Design	Frequency Response	Efficiency	Power / imp.
VAS18	Array sub	36,5 ~ 80,5Hz -3dB	96,5dB 1W / 1M	1400W AES/ 8ohm
Components	Kast: Berken multiplex 15mm			Netto inhoud 235Ltr
	18Sound 18LW1400 1000W/98dB 28-2500Hz			
Highpass 30Hz 4de order - 45Hz 8ste order EQ 45Hz/Q=2/G=-0,5dB 80Hz/Q=1/G=+1,5dB				
Ontwerp: van den Hoogen's Servicebedrijf / Boi van den Hoogen / www.soundshopschylge.nl / 23-02-2012				

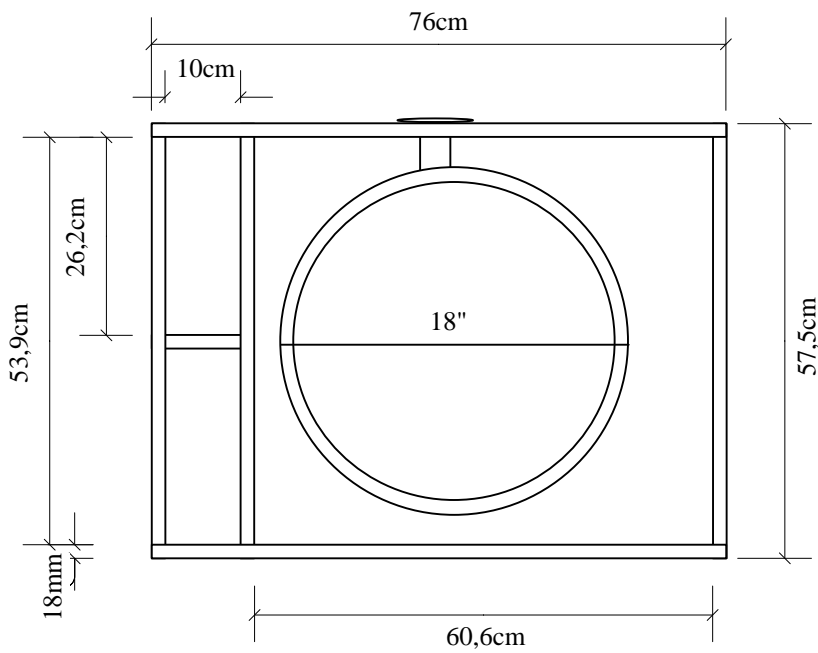
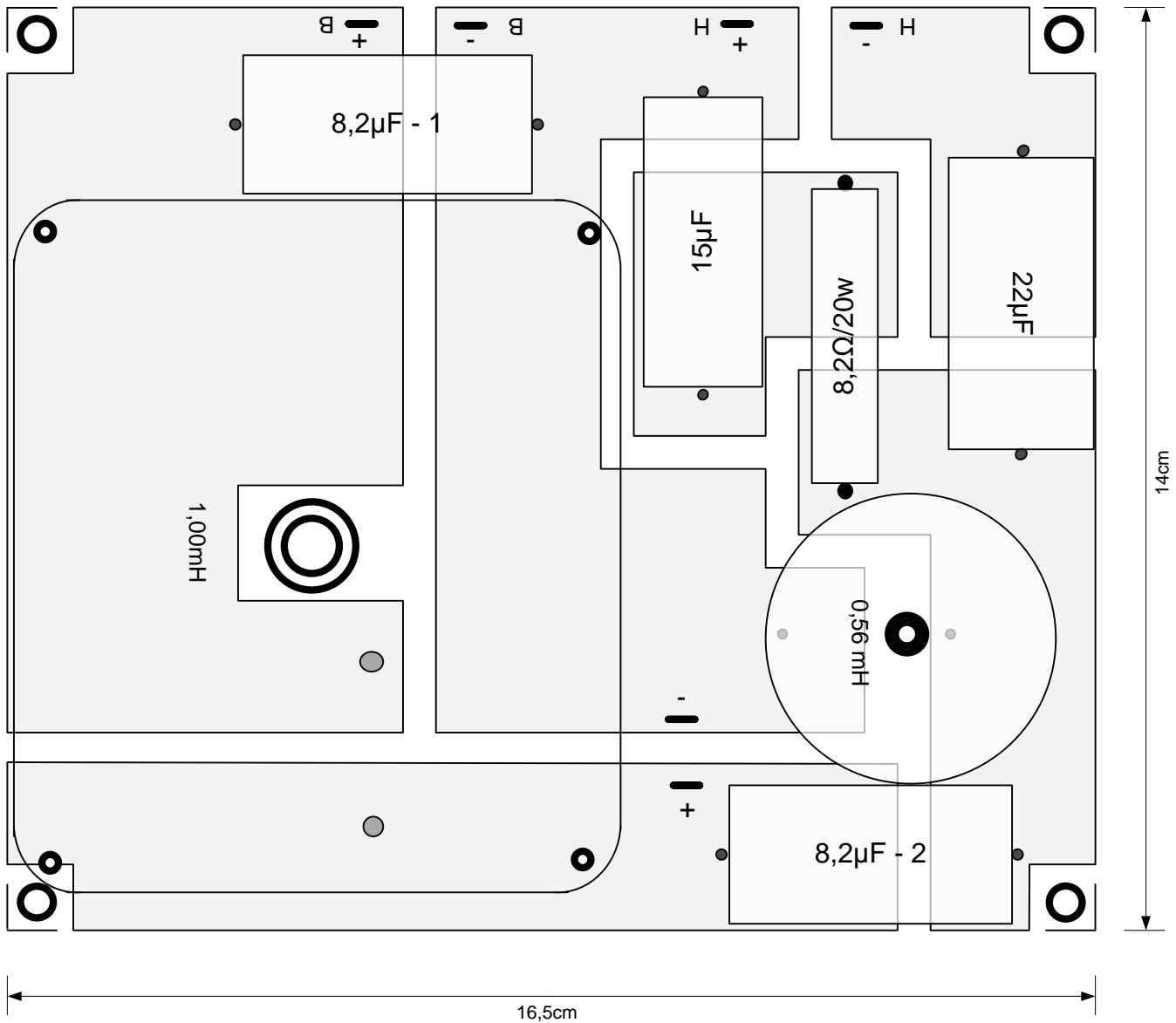

1500 w/8ohm 12/18dB filter

**E130/100/300**

DROSSELSPULE 1,0 MH R=0.08

**LU44/056/100**

LUFTSPULE 0.56 MH R=0.30

**Q4/8.20/400 - 1**

Audyn High End Audio capacitor Q4 MKP 8.20 MF/ 400 V 5% AXIAL

**MKPR/8.20/250 - 2**

AUDYN CAP MKP KONDENSATOR 8.20 UF 250 V RADIAL 5%

**MKPR/22.0/250**

AUDYN CAP MKP KONDENSATOR 22.0 UF 250 V RADIAL 5%

**MKPR/15.0/250**

AUDYN CAP MKP KONDENSATOR 15.0 UF 250 V RADIAL 5%

**WAX20/8.20/5**

DRAHTWIDERSTAND 8.20 OHM 20 WATT 5% AXIAL

